



Durakraft Extrusions Private Limited

Head Office: F-610, Aditya Corporate Hub, RDC, Rajnagar, Ghaziabad-201002

Plant: D-22, Meerut Road Industrial Area, Ghaziabad, U.P.-201003



www.durakraft.in



info@durakraft.in



+91 9266727424



Windows & Doors
by
DURAKRAFT

Crafted for Durability

Product Catalogue

DURAKRAFT
EXTRUSIONS
Durably Crafted uPVC Windows and Doors



As I gaze out my **window**,
I can see the raindrops
covering my windowpane,
The **kids playing** in the garden,
The **earthly smell** after the rain.

A **paper boat** in the water,
An **umbrella** floating in the sky,
The **trees swaying** in the breeze,
The **birds chirping** before they fly.

Struck by **nostalgia**,
as old **memories** come alive,
so vivid a **view from windowpane**,
wish I could **capture** on a drive.

If only I could go **back to childhood**,
still looking **silly and daft**,
Everything looks so **wonderful**,
when I view life through '**Durakraft**'.

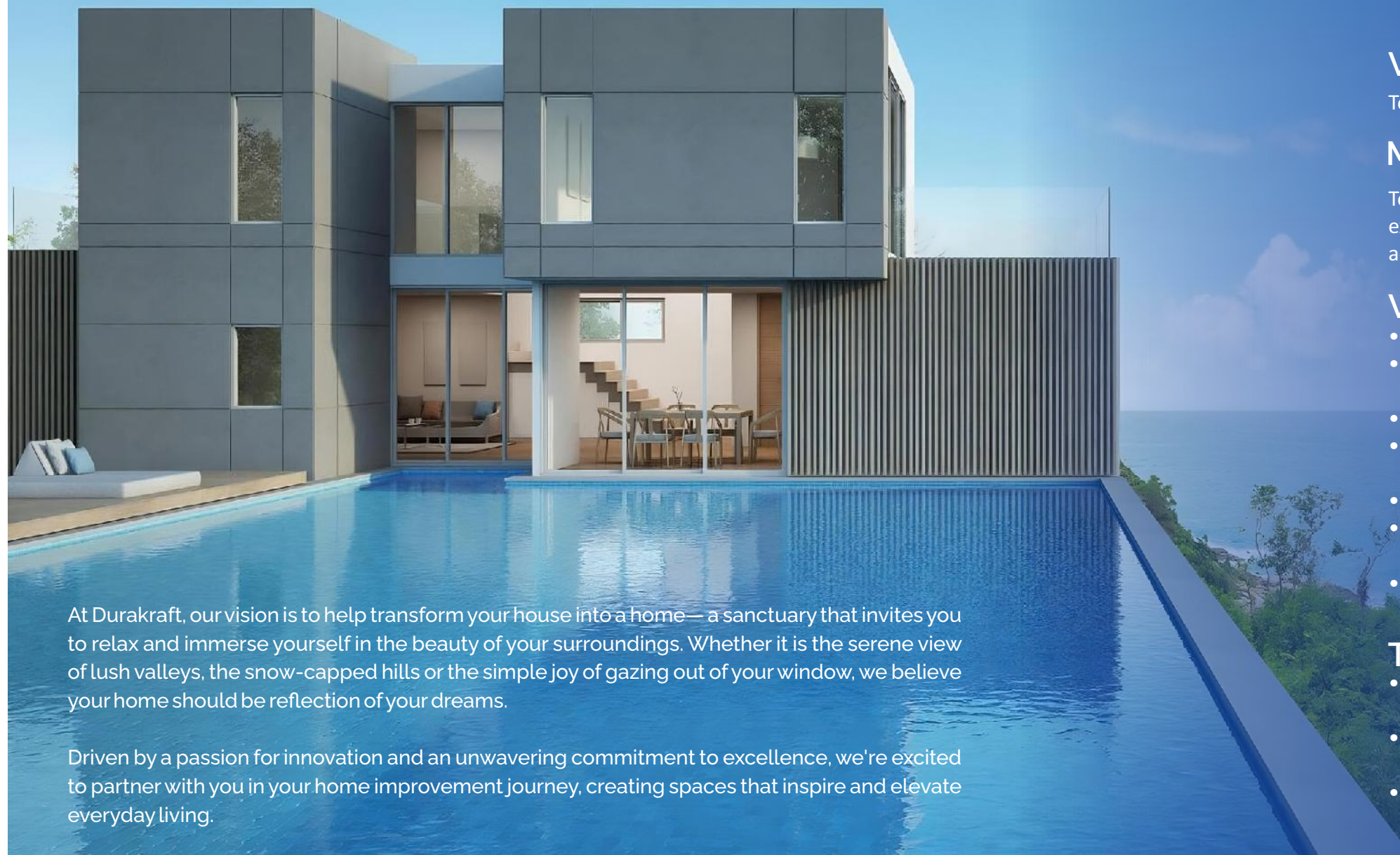

Vision

To be one of the top three uPVC Extrusion companies in the world

Mission

To surpass our customers' expectations and provide them with an exceptional experience by providing a durable profile with an aesthetic look backed up by the best service infrastructure.

Values

- **Quality:** High standards in durability and product excellence
- **Sustainability:** Environmentally conscious practices and waste reduction.
- **Innovation:** Constant improvement through new technologies.
- **Customer Focus:** Understanding needs and ensuring satisfaction.
- **Integrity:** Ethical, transparent business practices.
- **Collaboration:** Strong partnerships with suppliers, customers, and employees.
- **Safety:** Ensuring a secure work environment.

Team

- Promoted by graduates of NIT, IIM and SPA (School of Planning & Architecture).
- 25 years' expertise in import of high quality PVC resin and related ingredients
- Professional with more than 200+ Man years experience in UPVC Windows and Doors Profile Extrusion Industry.

At Durakraft, our vision is to help transform your house into a home— a sanctuary that invites you to relax and immerse yourself in the beauty of your surroundings. Whether it is the serene view of lush valleys, the snow-capped hills or the simple joy of gazing out of your window, we believe your home should be reflection of your dreams.

Driven by a passion for innovation and an unwavering commitment to excellence, we're excited to partner with you in your home improvement journey, creating spaces that inspire and elevate everyday living.

Casement Window



Choose flexibility and variety with our Casement Window range, designed to fit any window project seamlessly

Our casement window range is designed to fit any window project seamlessly.

The unmatched flexibility empowers customers with a wide variety of options perfectly tailored to their requirements. These windows blend perfectly with the current architectural design of the house and provide an ethereal experience to the consumer.

“When one door closes, another window opens.”
Julie Andrews

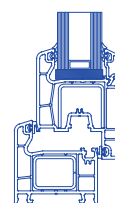

Product Detail

- Sleek and modern soft-line profile design
- 10 mm sash overlap for optimized performance
- Glazing options 4 mm to 32 mm in 60 standard casement series and 4 mm to 22 mm in 50 eco casement series
- Choose between single or multi-point locking mechanisms
- Convenient built-in hardware placement for hinges, strikers, and more
- Secure hardware integration with steel reinforcements as the standard practice

Sliding Window

Sliding Windows offer platitude of options ranging from Single Track, Double track to three track. This results in marked flexibility for both fabricators and consumers.

These windows provide customers ability to customize with features such as fly screen to enhance its appeal. With various section sizes available, these sliding windows are suitable for both larger and smaller window openings. This versatility makes them an ideal choice for either replacing outdated windows or meeting the demands of the rapidly expanding construction sector.

The Sliding Window range offers versatile options for both fabricators and consumers, ideal for renovation or new construction in the growing industry.

“If a window of opportunity appears, don't pull down the shade.”
Tom Peters

Product Detail

- 2 track , 2.5 track, 3 track and monorail (1 track) options with flymesh
- Sliding window frame depth range in standard Sliding window are 60 , 84 , 94, & 108 mm
- Eco Sliding system Frame depth range are 50, 80 & 90 mm
- Glazing options in Standard Sliding 4 mm to 18 mm And In eco Sliding system 4 mm to 8 mm
- Choice of single or multi-point locking devices for security.

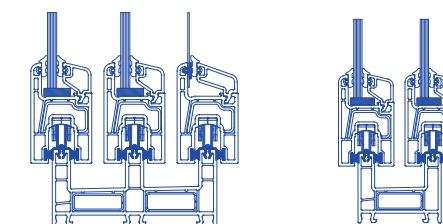

Tilt & Turn Window



Tilt & Turn windows provide versatile ventilation and style, ideal for spaces requiring enhanced airflow and comfort.

Durakraft Tilt & Turn windows stand out as exceptionally versatile option. They boast multifunctionality, with the ability to tilt open at the top, offering controlled ventilation when needed, and swing open like doors for maximum airflow. The tilting feature keeps rain out while ensuring a well-ventilated room, all easily managed with a simple handle turn. These windows ensure both durability as well as aesthetic appeal. They are meant them for spaces requiring added ventilation and comfort.

“Better keep yourself clean and bright: you are the window through which you must see the world”
George Bernard Shaw

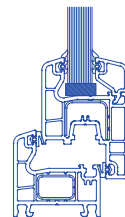

Product Detail

- Contemporary, sleek soft-line profile design
- Enhanced performance with a 10 mm sash overlap
- Glazing options 4 mm to 32 mm
- Weather-resistant concealed heavy-duty hinges for easier cleaning and enhanced security
- Secure hardware fitting with standard steel reinforcements

Vertical Sliding Window

Durakraft Vertical slider windows are an ideal choice when you require a window that is taller than it is wide, adhering to the golden ratio of 1:1.618. These windows are particularly effective when you need selective ventilation or an emergency exit option, as they allow one part of the window to open independently. In such cases, vertical slider windows offer a practical and aesthetically pleasing solution for your needs. Their versatile design not only complements the aesthetics of your space but also ensures efficient airflow and safety in case of emergencies, making vertical slider windows a practical and stylish choice for your window needs.

Vertical slider windows combine elegant design with practical functionality, making them an ideal choice for tall openings and selective ventilation needs.

“Follow your bliss and the universe will open doors where there were only walls”
Joseph Campbell

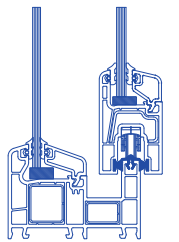

Product Detail

- Sleek and contemporary soft-line design
- Enhanced performance with a 10 mm sash overlap
- Versatile internal glazing options ranging from 4 mm to 18 mm
- Window can be open upward without requiring much space
- Customized special spiral balances to match sash weight and frame size
- Sash weight limitation with glass and hardware is 13.5 kg for vertical sliding window

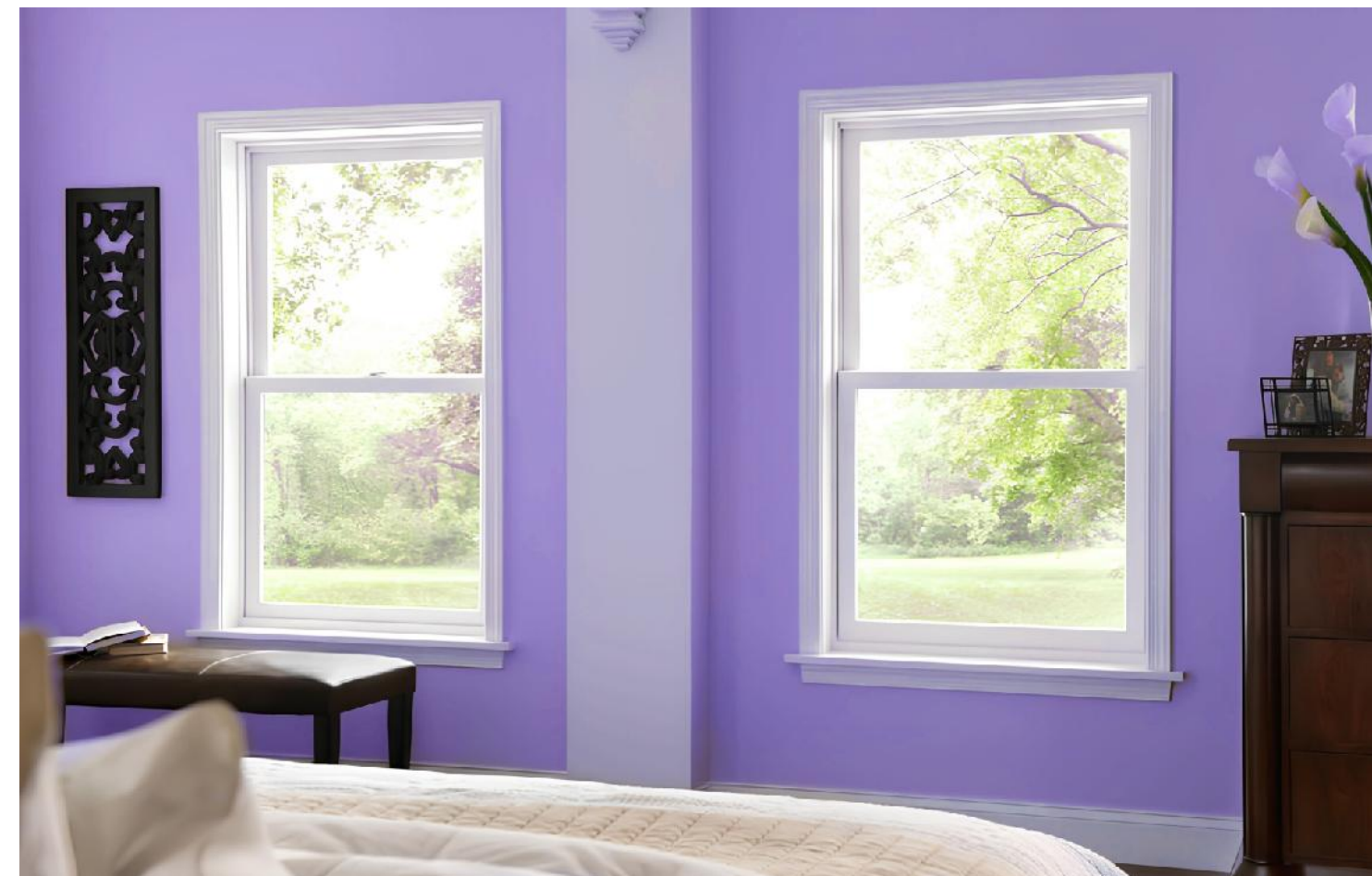

Casement Door



Elevate your entryway with our stylish and versatile door solutions, offering a range of styles and configurations to suit your needs.

Discover a selection of doors that offer the convenience of opening in or out, available in single or double casement styles. These versatile doors can serve as the main entrance or as an access point to a balcony or patio. Choose from two profile depths, 62mm or 112mm, and opt for standalone doors or incorporate them into larger configurations with fan lights or side lights. If you're looking for a spacious entryway without a sliding door, our double doors, also known as French doors, are an excellent solution.

“Trust in God but lock your doors.
Russian Proverb”

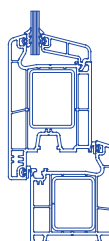

Product Detail

- Sleek and Modern Softline Aesthetics
- 10 mm Sash Overlap for Improved Performance
- Glazing options 4 mm to 32 mm
- Wide selection of multi-point locking mechanisms, including full perimeter locking
- Zero-threshold or Low Aluminum Threshold options
- Variety of hinge styles, including concealed hinges

Tilt & Turn Door

Durakraft's UPVC Tilt and Turn doors offer versatile, energy-efficient, and stylish entry solutions with a unique dual-action design.

The Durakraft UPVC tilt and turn doors are versatile and energy-efficient entrance solution that combines style and functionality. These doors feature a unique dual-action mechanism that allows them to either tilt inwards at the top for secure ventilation or swing open fully like a traditional door, providing ease of access and cleaning. Crafted from durable UPVC, they offer excellent insulation, noise reduction, and security, making them an ideal choice for homes and buildings. Durakraft UPVC Tilt and Turn doors are not only aesthetically appealing with their sleek design but also highly practical, offering homeowners a modern and adaptable entryway solution.

“We keep moving forward, opening new doors, and doing new things, because we're curious and curiosity keeps leading us down new paths.
Walt Disney”

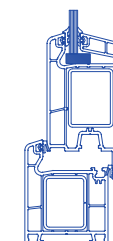

French Door



Brighten your living space with the timeless elegance of French Doors, seamlessly connecting indoors and outdoors with sophisticated style.

Durakraft French Doors, also known as double doors or double windows, offer a sophisticated means to seamlessly connect your home with the outdoor surroundings. Typically situated at the rear of the residence, they provide access to gardens or balconies. This concept of twin doors that swing open without an intervening barrier dates back to the 17th century and has significantly impacted French architectural aesthetics, contributing to the timeless elegance and grandeur seen in numerous European structures.

“If a window of opportunity appears, don't pull down the shade.” - Tom Peters

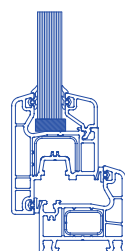

Product Detail

- Casement sashes suitable for French doors and French windows
- Available in opening-out and open-in modes
- Glazing options 4 mm to 32 mm
- Choice of numerous multi-point locking devices, including full perimeter locking
- French doors available threshold-less or with Aluminum low threshold
- Variety of hinge types, including concealed (invisible) hinges

Sliding Door

Experience unmatched flexibility with our Sliding Doors range, spanning frame depths from 62mm to 142mm, offering versatile configurations for small and large openings.

The Durakraft Sliding Doors range, encompassing frame depths from 62mm to 142mm, is thoughtfully designed to provide maximum flexibility for fabricators and clients alike. Utilizing a range of sections, it offers complete adaptability, accommodating single sliding to multiple sliding openers, clip-on or integrated sections for fly screens, and various section sizes suitable for both small and large openings.

“If opportunity doesn't knock, build a door.”
Milton Berley

Product Detail

- 2 track, 2.5 track, 3 track and monorail (1 track) options with flymesh
- 10 mm sash overlap for improved functionality
- Glazing options 4 mm to 18 mm
- Frame depth 60, 84, 94 & 108 mm

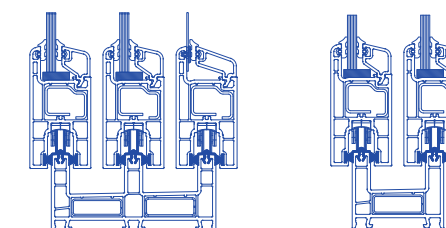

Fold & Slide Door



Attributes



Sound proof



Termite Resistant



Corrossion Proof



Fire Retardant



Security



Durability



Weather Resistant



Thermal Insulation

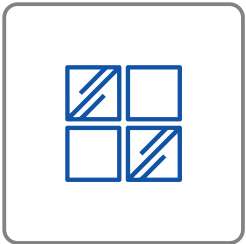

Aesthetics



Eco-friendly



Customizable

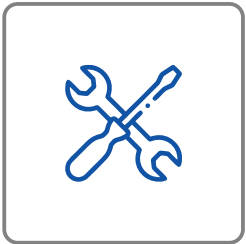

Low Maintenance

Elevate your space with aesthetic visual appeal of Fold N Slide Doors system, combining superior performance, secure engineering, and seamless architectural integration.

The Durakraft Fold N Slide Doors system offers exceptional operational performance and seamless integration with diverse architectural styles and spaces. This door system is meticulously crafted using top-tier uPVC window and door profiles, featuring high-quality hinges and locking mechanisms that guarantee reliability and security. The door's sliding mechanism is built upon robust design principles and expert engineering, ensuring a consistently smooth and dependable performance.

Product Detail

- Modern and Stylish Softline Aesthetics
- 10 mm Sash Overlap for Improved Performance
- Glazing options 4 mm to 32 mm
- Standard Multi-Point Perimeter Locking Mechanisms
- Sturdy Tandem Rollers for Effortless Operation
- Included Secure Hardware Fitted into Steel Reinforcements

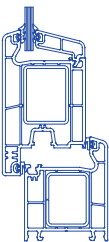

“When one door closes, another opens; but we often look so long and so regretfully upon the closed door that we do not see the one which has opened for us
Alexander Graham Bell”

Salient Points



Complies with **EN12608-1:2016** and **ISO:17953** standards for Unplasticized PVC Materials.

Made for Indian conditions ranging from **-10°C to +60°C**



Well-engineered extrusion dies, calibrators, tank plates and turbo cooling tanks design in-house and manufactured by **high-quality German alloy tool steel**.



What Sets Us Apart: Quality, Innovation, and Value

- **Durakraft profiles are crafted for durability, performance, and cost-efficiency. Here's what makes us stand out:**
 - **Premium Raw Materials:** Sourced from trusted global suppliers for unmatched strength and longevity.
 - **Low Filler Content:** Minimal filler ensures superior impact resistance and long-term performance.
 - **High TiO₂ for Whiteness:** High TiO content guarantees lasting brightness and enhanced UV stability.
 - **Economical & Easy to Fabricate:** Designed for cost-effectiveness and simplified fabrication for builders and fabricators.
 - **Modular Design:** Flexible and easy to install across diverse applications.
 - **Minimized Inventory, Maximized Options:** Fewer profiles, more design choices, and reduced inventory costs.
 - **Common Accessories & Standard Hardware:** Budget-friendly, high-quality solutions for both residential and commercial projects.
 - **Expertise & Leadership:** Industry leadership with expertise from top institutions like NIT, IIM, and SPA Delhi.
 - **Commitment to Excellence:** Rigorous quality control and advanced technology to meet global standards.
 - **Extensive Product Range:** Nearly 50 profiles to suit a wide range of applications.
 - **Certifications:** ISO 17953, UWDM, ISO 9001:2015, ISO 14001:2015 certified, with CIPET-approved testing.

Durakraft delivers the perfect combination of quality, innovation, and value—making our profiles the ideal choice for builders, fabricators, and developers worldwide.



Certification





uPVC VS Aluminium

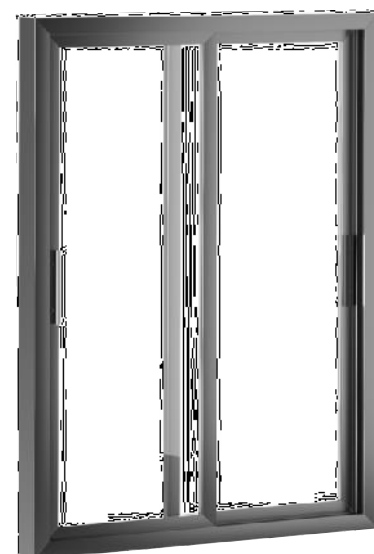

Cost: uPVC profiles are generally more cost-effective compared to aluminum.



Durability: uPVC profiles resist corrosion, rot, and rust, providing long-lasting performance.



Insulation: uPVC profiles offer superior thermal insulation, reducing heat loss and energy consumption.



Maintenance: uPVC profiles require minimal maintenance, typically just needing cleaning with soap and water.



Environmental Impact: uPVC profiles may have a slight advantage in recyclability compared to aluminum.



Sound Insulation: uPVC profiles provide better sound insulation, contributing to a quieter indoor environment.

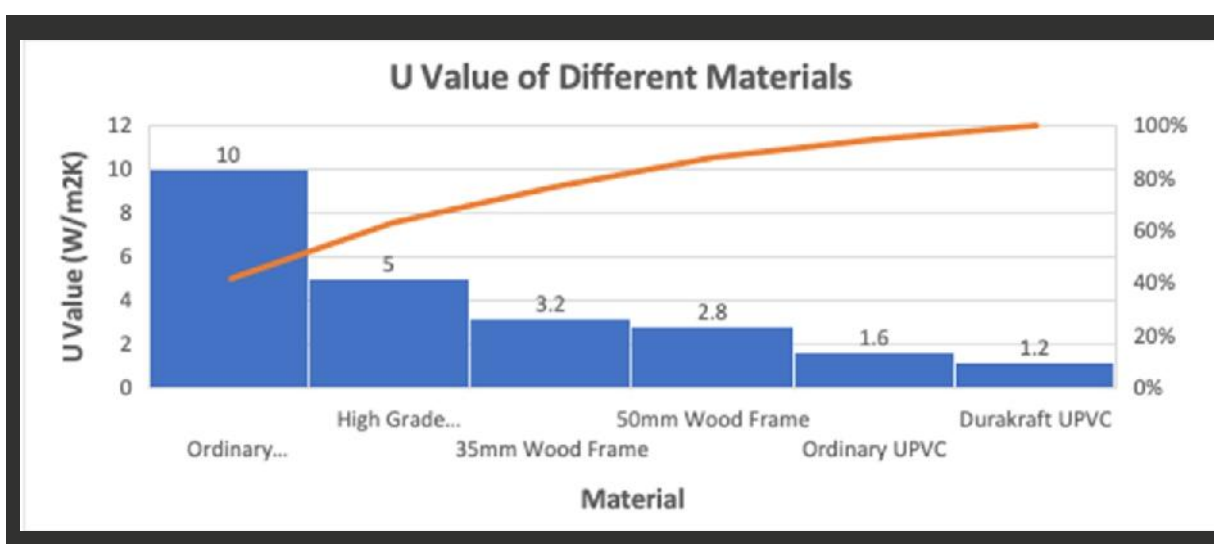

A Window is like hope. It strengthens our belief in freedom. There is nothing more profound, more mysterious and more dazzling than a window. In a way, a window is like window to our soul. It makes things look better on the other side.

As **Walt Whitman** once said; ““A morning-glory at my window satisfies me more than the metaphysics of books.” it is better to look out at the world through a window than through a mirror. Otherwise, all you see is yourself and whatever is behind you. Sometimes things as simple as gazing out of the windows work wonders for the soul.

Needless to say, Durakraft Windows and Doors profiles have been designed to make your day beautiful.

